

You can add a gable overhang frame to your truss layout by using the 'TDT' for 'Truss Detaler' command.

To do this, select three points as shown in our example. When prompted for the first roof type, press 'M' for 'More', then select 'Gable Frame' off the selection.

Mission is now complete.

You will need to repeat this process for each required 'Gable Frame'.

Before adding a 'Gable Frame' please ensure that it is within the capabilities of your framing system and the data file is correctly enabled..

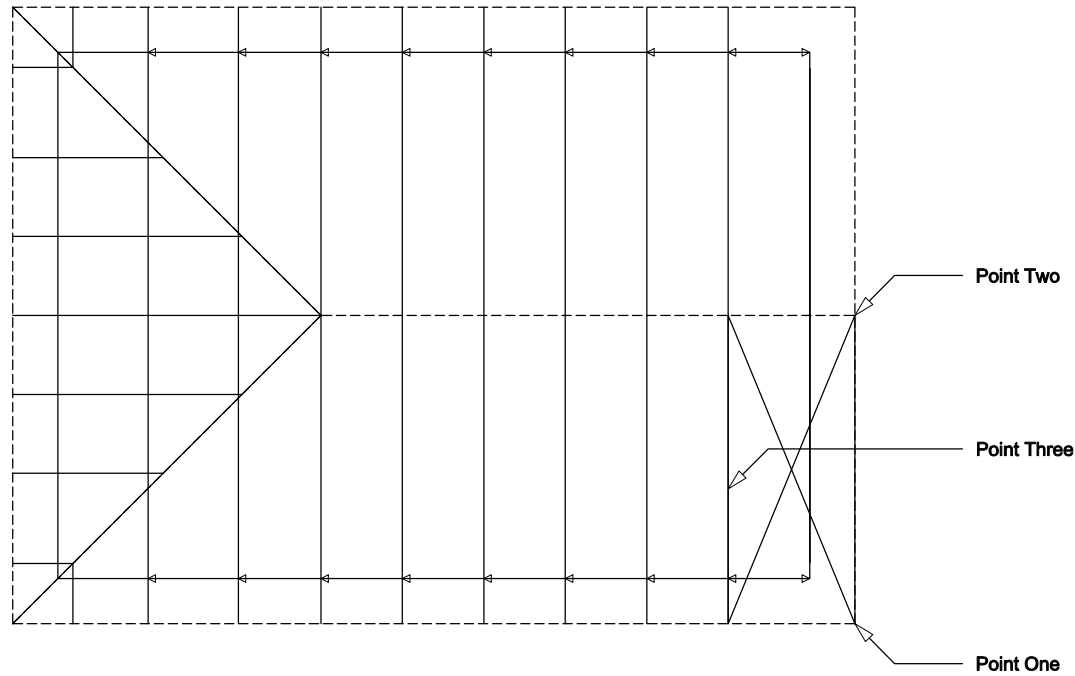

For the more experienced operator, instead of pressing 'M' for 'More', one could simply enter 'GF' and this would have the same outcome.

Please Note: These gable frames do not appear in the 'T3D' drawings, nor is the software capable of doing an analysis on them. This may change in the future, but currently there are no plans for this.